

ROADMAXX® SYSTEM

Carbide Insert Underbody Blade

29% MORE CARBIDE*

Than standard carbide insert blades

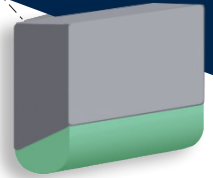
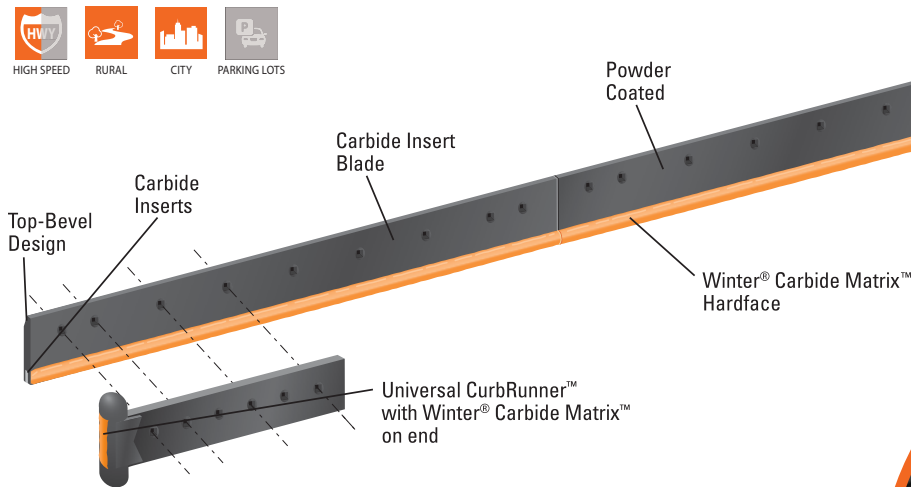

Hard-Faced Underbody Blades with HammerHead™ Inserts

- **Increased Blade Life** - A HammerHead™ carbide insert underbody blade strengthened with Winter® Carbide Matrix™ on the blade face that will increase the life of the blade.
- **Carbide Washout Prevention** - Front edge Carbide Matrix™ weld reduces washout from end to end.
- **Multiple Attack Angles** - The HammerHead™ design allows for high wear protection & maximum performance at most attack angles.
- **High Wear Protection** - Two WINTER® PLOWGUARDS protect against premature curb wear and moldboard damage.
- **Top bevel Feature** - Allows the blade to sit flush on the moldboard of an underbody or grader.
- **All Season Blade System** - High quality steel provides toughness that can plow city streets, and cut or move earth on rough county roads eliminating blade changes from season to season.

ROADMAXX® SYSTEM INCLUDES

- Three Roadmaxx® blades.
- Two PlowGuard CurbRunners with Winter® Carbide Matrix™ to protect blade against premature wear.
- Grade 8 steel plow bolts, washers, and lock nuts in one kit
- Easy assembly instructions included. Down pressure recommendation of 400 lbs PSI to prevent blade failure.

PlowGuard Option



**ORDER YOUR
ROADMAXX® SYSTEM
USING ONE PART NUMBER**

Systems include free freight and arrive in an easy to inventory crate.

Satisfaction Guarantee

Visit winterequipment.com/guarantee

WINTER
We are cutting edge®

winterequipment.com

800-294-6837

ROADMAXX® SYSTEM

Underbody Carbide System

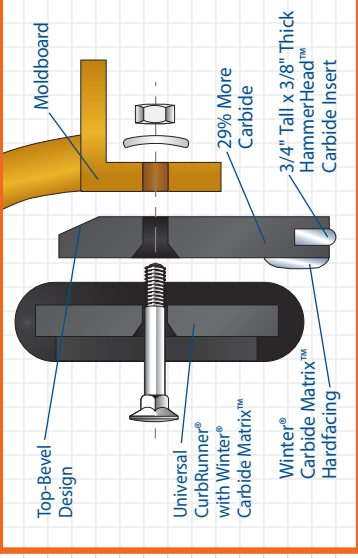

RoadMaxx® HammerHead™ carbide insert blade, strengthened with Winter® Carbide Matrix™ contains 29% more carbide than standard carbide insert blades. Unique design allows for multiple attack angles.

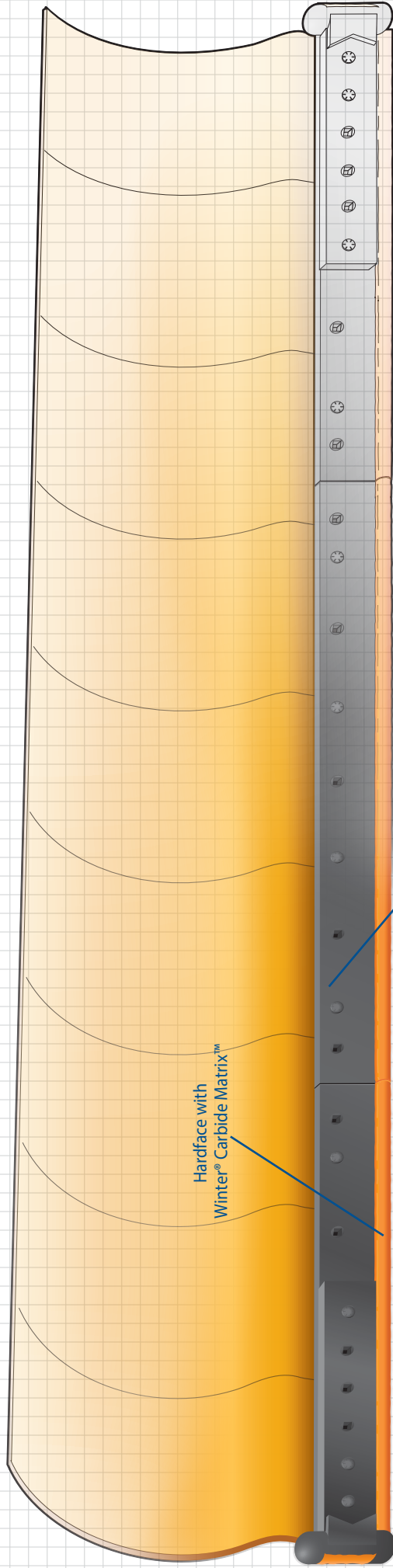

Universal CurbRunner® Guard with Winter® Carbide Matrix™

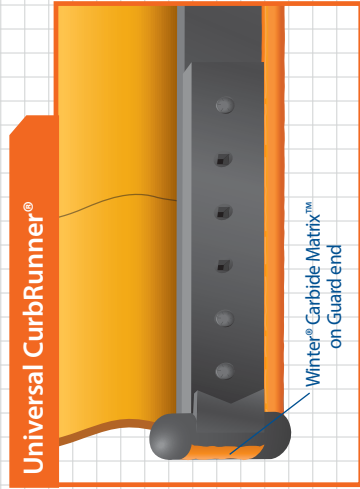

Two Universal CurbRunner® Guards included with each system.

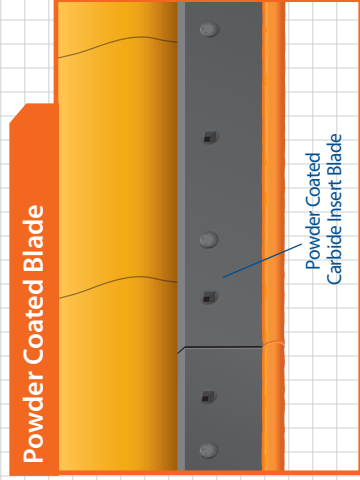

Three powder coated carbide insert blade segments with Winter® CarbideMatrix™ hardface reduces washout from end to end.

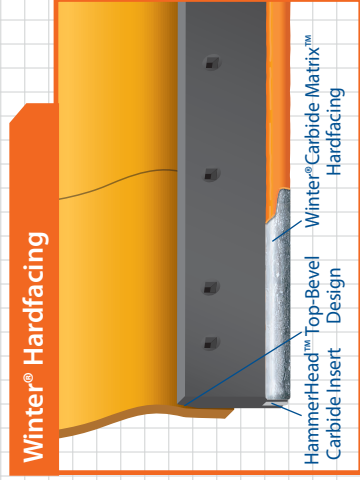

RoadMaxx® bull nose carbide insert underbody blade, strengthened with Winter® Carbide Matrix™ on the blade face, increases the life of the system.

	
RoadMaxx® Underbody Carbide System	
Address: 1900 Joseph Lloyd Parkway, Willoughby, Ohio 44094 Telephone: (800) 294-6837 Fax: (888) 810-9363 sales@winterequipment.com www.winterequipment.com	